

ITT

RSSHSMGR

Commercial Water

Goulds Pumps

SSH REPAIR PARTS

Effective January, 2008

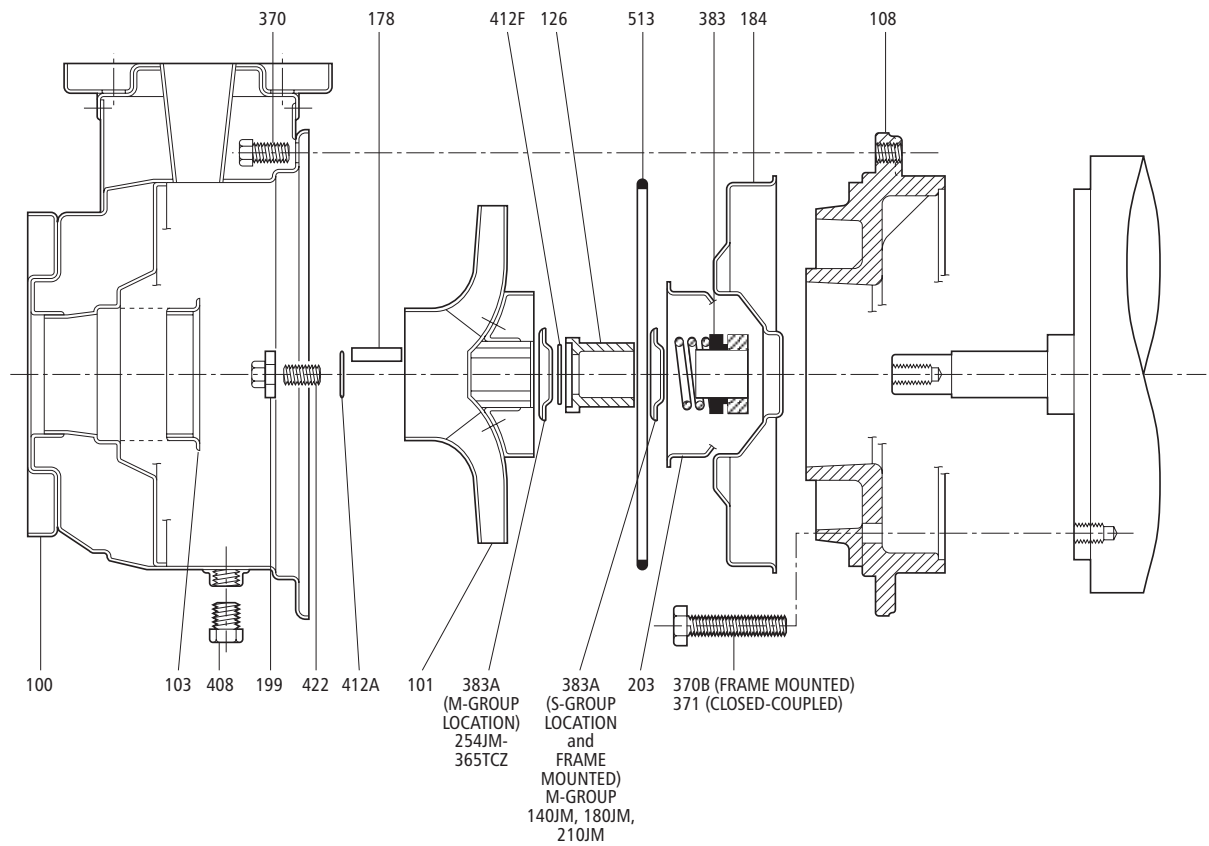

Goulds Pumps is a brand of ITT Corporation.

www.goulds.com

Engineered for life

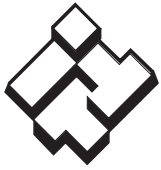

ITT

GOULDS PUMPS
Commercial Water

SSH S-Group

Item No.	Part Description	Material	1 x 2-6		1½ x 2½-6	2 X 2½-6	2½ x 3-6	1 x 2-8		1½ x 2½-8	2 x 2½-8	1 x 2-10		Max. Wt. (lbs.)								
			①	②	4SH	5SH	6SH	①		7SH	8SH	①										
			9SH 9A-SH	9SH Before Jan. 2003				10SH 10A-SH	10SH Before Jan. 2003			11SH 11-SH	11SH Before Jan. 2003									
100	Casing with wear ring		1L450		1L453	1L456	1L459	1L451		1L454	1L457	1L452		17								
101	Impeller	AISI Type 316SS	6⅝	2L889	2L856	6¾	2L876	6⅞	2L766	7⅞	2L771	8⅞	2L898		8¼	2L879	8¼	2L770	10⅜	2L897	2L865	
			6⅞	2L888	2L733	6⅞	2L874	6⅞	2L765	7⅞	2L772	8⅞	2L893	2L861	7⅞	2L756	7¾	2L769	9⅞	2L896	2L742	
			5⅞	2L887	2L853	6⅞	2L872	5⅞	2L763	6⅞	2L773	7⅞	2L892	2L859	7	2L877	7½	2L768	9⅞	2L895	2L863	
			5⅞	2L886	2L730	5⅞	2L871	5½	2L882	6⅞	2L774	7⅞	2L891	2L858	6¾	2L876	7⅞	2L767	8¼	2L894	2L862	
						5⅞	2L870	5⅞	2L881	6⅞	2L775	7⅞	2L890	2L735	6⅞	2L875	6⅞	2L766				
						4⅞	2L869	4⅞	2L880	6⅞	2L776				6⅞	2L751	6⅞	2L764				
						4⅞	2L868	4⅞	2L759	5⅞	2L777											
			4⅞	2L867																		
103	Wear ring, casing		4L465		4L466	4L467	4L468	4L465		4L466	4L467	4L465		1								
184	Seal housing with ring		1L465			1L469	1L472	1L466			1L470	1L467	3									
203	Wear ring, seal housing		4L201				4L464	4L201														
126	Shaft sleeve	316SS	4L473	4L456				4L473	4L456			4L473	4L456									
178	Key, impeller	Steel	4K11				4K555	4K11			4K555	4K11	1									
422	Stud, impeller		13K217																			
199	Washer, impeller	316SS	4L458																			
108	Motor adapter, 143-184JM and S-group brg. frame	Cast iron ASTM A48	1L554	1L50			1L99	1L560	1L52	1L99	1L562	1L97	25									
	Motor adapter, 213-256JM	d. 20	1L555	1L51			1L98	1L561	1L53	1L98	1L563	1L96	29									
370	Bolt, casing	300SS	13L38 (8 req.)				13L89	13L38 (8 req.)			13L89 (8 req.)			-								
371 or 370B	Bolt, adapter, 143-184JM and S-Group brg. frame	Steel SAE 1200	13K360	13L43			13L43	13K360	13L43	13L43	13K360	13L43	25									
	Bolt, adapter, 213-256JM		13K379	13L41			13K245	13K361	13L40	13K245	13K361	13L40	29									
383	Mech. seal – standard	Type 21	10K27 – carbon/silicon-carbide/ viton										1									
	Mech. seal – high temp.		10K19 – Carbon/silicon-carbide/EPR																			
	Mech. seal – severe duty		10K64 – Silicon-carbide/silicon-carbide/viton																			
383A	Retainer, seal spring	316SS	4K517																			
408	Plug, vent and drain	316SS	6L19										2									
412A	O-ring, impeller washer	Viton	5K320 standard (5K195 EPR option)										1									
412F	O-ring, shaft sleeve	Viton	5K307 standard (5K306 EPR option)																			
513	O-ring, casing – standard	Viton	5K407			5L70	5K408			5L70	5L71											
	O-ring, casing – optional	EPR	5K393			5K317	5K394			5K317	5L110											

① 9SH, 10SH and the 11SH units were obsoleted in January 2003 and replaced by the 9ASH, 10ASH and 11ASH units.

② New numbering system on September of 2006 dropped the "A". There was no mechanical change.



ITT

GOULDS PUMPS
Commercial Water

SSH M-Group (254JM-365TCZ)

Item No.	Part Description	Material	1½ x 2½-10 24SH		2 x 2½-10 25SH		2½ x 3-8 22SH		2½ x 3-10 27SH		3 x 4-8 23SH		3 x 4-10 28SH		Max. Wt. (lbs.)
			1L455	1L458	1L460	1L461	1L463	1L464							
100	Casing, with wear ring	AISI Type 316L SS													17
101	Impeller		9⅞	2L778	9⅞	2L790	9⅞	2L808	10⅜	2L804	9⅞	2L825	10⅞	2L836	8
			9½	2L779	9½	2L791	8¾	2L809	9⅞	2L805	8⅞	2L826	10¼	2L837	
			9⅞	2L780	9⅞	2L792	8½	2L810	9⅞	2L806	8⅞	2L827	9⅞	2L838	
			8⅞	2L781	8⅞	2L793	8¼	2L811	9¼	2L807	8⅞	2L828	9⅞	2L839	
			8⅞	2L782	8⅞	2L794	7⅞	2L812	8¾	2L809	7⅞	2L829	9⅞	2L825	
			8¼	2L783	7⅞	2L795	7½	2L813			7½	2L830	8⅞	2L826	
					7⅞	2L796	7⅞	2L814			7⅞	2L831			
							6⅞	2L815			6⅞	2L832			
							6½	2L816			6½	2L833			
											6	2L834			
									5½	2L835					
103	Wear ring, casing			4L467		4L468		4L469						1	
184	Seal housing, with ring			1L468		1L473	1L475	1L477	1L478					3	
203	Wear ring, seal housing		4L201		4L464										
126	Shaft sleeve	316 SS			4L457								1		
178	Key, impeller	Steel			4K261										
422	Stud, impeller				13K301										
199	Washer, impeller	316 SS			4L463										
108	Motor adapter, 254-256JM and M-Group bearing frame	Cast iron ASTM A48 cl. 20	1L91		1L89	1L93		1L94						31	
	Motor adapter, 280JM-365TCZ		1L90		1L88	1L92		1L95						44	
370	Bolt, casing	300 SS	13L86 (6 req'd)		13L89 (8 req'd)	13L86 (8 req'd)		13K45 (8 req'd)						–	
371 or 370B	Bolt, adapter, 254-256JM and S-Group bearing frame	Steel SAE 1200	13L88		13L116								–		
	Bolt, adapter, 280JM-365TCZ		13L87		13L115								–		
383	Mech. seal – standard	Type 21			10K45 – carbon/silicon-carbide/viton								1		
	Mech. seal – high temp.				10K20 – Carbon/silicon-carbide/EPR										
	Mech. seal – severe duty				10K65 – Silicon-carbide/silicon-carbide/viton										
383A	Retainer, seal spring	316SS			4K500								2		
408	Plug, vent and drain	316SS			6L19										
412A	O-ring, impeller washer	Viton			5K309 standard (5K308 EPR option)								1		
412F	O-ring, shaft sleeve	Viton			5K309 standard (5K308 EPR option)										
513	O-ring, casing – standard	Viton	5L71		5L70	5L71		5L72							
	O-ring, casing – optional	EPR	5L110		5K317	5L110		5L116							



ITT

Commercial Water

SSH M-Group (140JM, 180JM & 210JM)

Item No.	Part Description	Material	1½ x 2½-10 24SH	2 x 2½-10 25SH	2½ x 3-8 22SH	2½ x 3-10 27SH	3 x 4-8 23SH	Max. Wt. (lbs.)					
100	Casing, with wear ring	AISI Type 316L SS	1L455		1L458		1L460		17				
101	Impeller		9/8	2L784	9/8	2L797	9¼	2L820	9½	2L817	8		
			9½	2L785	9½	2L798	8½	2L822	9¼	2L818		8½	2L841
			9¾	2L786	9½	2L799	8¾	2L823	9¼	2L819		8½	2L842
			8¾	2L787	8¾	2L800	7¾	2L824	8¾	2L821		7½	2L843
			8½	2L788	8¾	2L801	7¾	2L772				7½	2L844
			8¼	2L789	7¾	2L802	6¾	2L774				6½	2L845
					7¼	2L803						6	2L846
103	Wear ring, casing			4L467		4L468		4L469		1			
184	Seal housing, with ring			1L467		1L472		1L474		3			
203	Wear ring, seal housing		4L201		4L464				1				
126	Shaft sleeve	316SS	4K501		4L456								
178	Key, impeller	Steel			4K11								
422	Stud, impeller				13K217								
199	Washer, impeller	316 SS			4L458								
108	Motor adapter, 143-184JM and S-group bearing frame	Cast iron ASTM	1L97		1L99		N/A		25				
	Motor adapter, 213-256JM	A48 cl.20	1L96		1L98		1L100		29				
370	Bolt, casing	300 SS	13L86 (8 req'd)		13L89 (8 req'd)		13L86 (8 req'd)		–				
371 or 370B	Bolt, adapter, 143-184JM and S-group bearing frame	Steel SAE 1200	13L43		N/A		13L117		–				
	Bolt, adapter, 213-256JM		13K245				13K44		–				
383	Mechanical seal – standard	Type 21	10K27 – carbon/silicon-carbide/ viton						1				
	Mechanical seal – high temp.		10K19 – Carbon/silicon-carbide/EPR										
	Mechanical seal – severe duty		10K64 – Silicon-carbide/silicon-carbide/viton										
383A	Retainer, seal spring	316 SS	4K517						2				
408	Plug, vent and drain	316 SS	6L19										
412A	O-ring, impeller washer	Viton	5K320 standard (5K195 EPR option)						1				
412F	O-ring, shaft sleeve	Viton	5K320 standard (5K195 EPR)		5K307 standard (5K306 EPR option)								
513	O-ring, casing – standard	Viton	5L71		5L70		5L71						
	O-ring, casing – optional	EPR	5L110		5K317		5L110						



Goulds Pumps and the ITT Engineered Blocks Symbol are registered trademarks and tradenames of ITT Corporation.

SPECIFICATIONS ARE SUBJECT TO CHANGE WITHOUT NOTICE.

RSSHSMGR July, 2008

© 2008 ITT Corporation

Engineered for life